

Optical Reader Datasheet



ADDRESS: Ikitelli OSB Mah. Cevre
14. Blok Sok. Telas Blok Dis Kapi
No: 1 Kat: 1-2 Basaksehir/Istanbul

Phone: +90 212 438 80 24
Fax: +90 212 438 80 25

info@gruparge.com

1.1. General Features

The Optical Reader is designed to enable data exchange with electronic meters by communicating via the IEC1107 (IEC62056-21) protocol.

The optical reader is used so that GSM or Ethernet-based modems used for communication with meters can read data from the meters.

The optical reader must be positioned so that the arrow on it points upward, aligned with the metal surface on the optical port of the electricity meter.

1.2. Technical Features

- **Communication Protocol:** IEC1107 (IEC62056-21).
- **Cable Cross-Section and Length:** 4 x 0.22 mm², 2.5 m
- **Operating Temperature:** -10 °C / +55 °C
- **Magnet:** Neodymium Magnet.
- **Connection Type:** Terminal Connection.
- **Weight:** 100 gr (with cable).
- **Mounting:** Mounting on the metal surface of the optical port.
- **Protection Class:** IP20.
- **Max. Connection Speed:** 19200 bps.

1.3. Technical Drawing

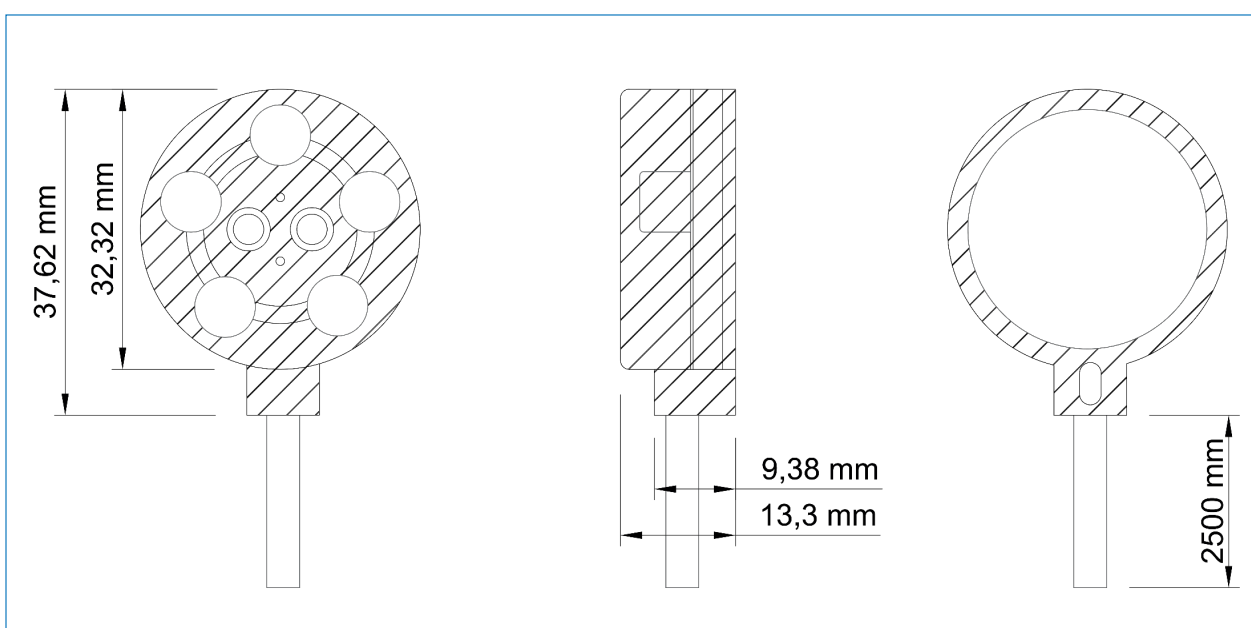

1.4. Connection Diagram

1.4.1. GSM Automation Terminal - Optical Reader Connection Diagram

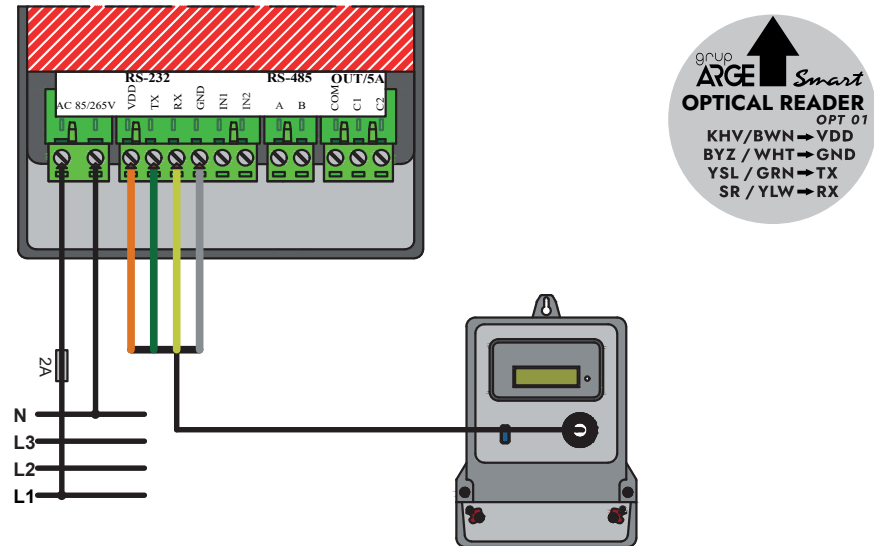

1.4.2. Ethernet Terminal - Optical Reader Connection Diagram

